

MALAGATA ROOM

MALAGATA MEOW!

Welcome to **Malagata**, the new **Gat Rooms** meeting room in Lisbon's city centre!

Spacious, comfortable and hosting up to 50 people, as its name points out (mala means suitcase in Portuguese) **Malagata** is the perfect option for traveller cats: bleisure (business and leisure) under the same roof; easy access not to waste a minute in getting to your meeting.

And if between sessions you feel like exploring around, in less than 5 minutes you can enjoy shopping in Chiado, indulge yourself in Confeitaria Nacional one of the most ancient in Lisbon-, try all sorts of restaurants, Lisbon typical cafés and, of course, its famous breweries and seafood restaurants to palate an amazing *bacalhau*.

Malagata offers business and leisure in a “sleep smart” environment, that is a centric, value conscious, affordable location passionate about design.

MARRAMIAU traveller cats, see you in **Malagata!**

Hotel **Gat Rossio**

Rua jardim do Regedor, 27-35
1150-193 Lisboa
T.: +351 213 478 300
F.: +351 213 478 301
Whatsapp: +351 925 005 436
hotelgatrossio@gatrooms.com

gatrooms.com

MALAGATA ROOM

Features and services

- Multifunctional room for conferences, meetings cocktails and showrooms
- Capacity: up to 1.500 pax.
- Completely refurbished with modern and functional furniture
- Latest technology and audiovisual facilities
- Open room with natural light and totally soundproof
- With easy access for exhibition products
- At city center: 15 minutes from Lisboa airport, next to the Rossio central train station and the Restauradores Metro statio
- Public parking (3 minutes)
- Conference Concierge at your disposal before and during the event
- Coffe breaks service
- Catering under request

Hotel Gat Rossio

Rua jardim do Regedor, 27-35
1150-193 Lisboa
T.: +351 213 478 300
F.: +351 213 478 301
Whatsapp: +351 925 005 436
hotelgatrossio@gatrooms.com

gatrooms.com

MALAGATA ROOM



Hotel Gat Rossio

Rua jardim do Regedor, 27-35
1150-193 Lisboa
T.: +351 213 478 300
F.: +351 213 478 301
Whatsapp: +351 925 005 436
hotelgatrossio@gatrooms.com

gatrooms.com

Planta baja (acceso)

Access	1
Goods access	2
Hotel / Meetings Reception	3
Waiting room	4
Toilets	5
Hotel access	6
Meetings warehouse	7
Offices	8

MALAGATA ROOM

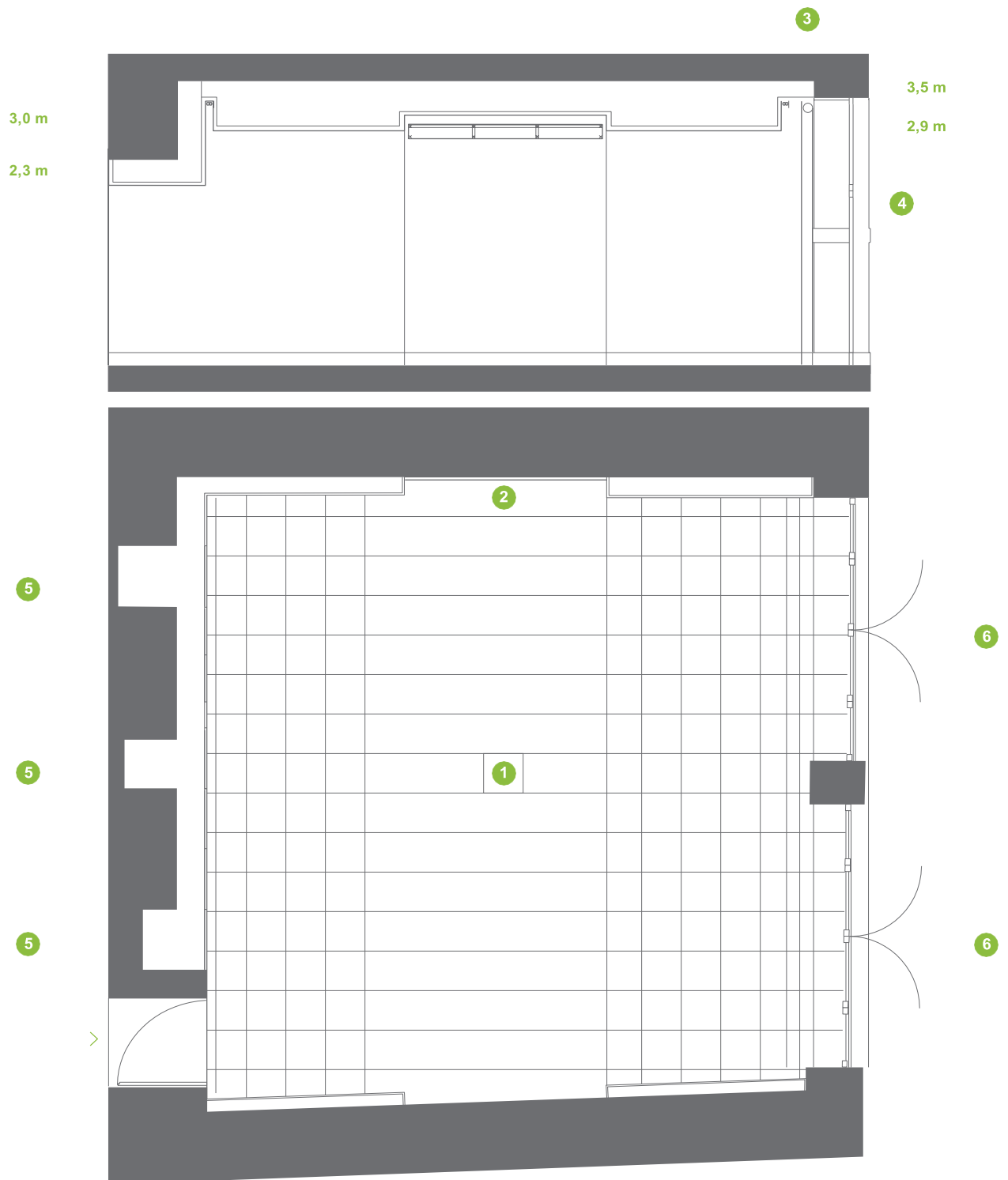

Hotel Gat Rossio

Rua jardim do Regedor, 27-35
 1150-193 Lisboa
 T.: +351 213 478 300
 F.: +351 213 478 301
 Whatsapp: +351 925 005 436
 hotelgatrossio@gatrooms.com

Dimensions

Surface	58 m ²
Length	7,60 m
Width	7,64 m
Height	3,0 m
Grid	0,5 x 0,5 m

Equipment

Ceiling projector	1
Roll up projection screen	2
Electronic block out blinds	3
Electronic curtain	4
Furniture storage room	5
Natural light	6

MALAGATA ROOM

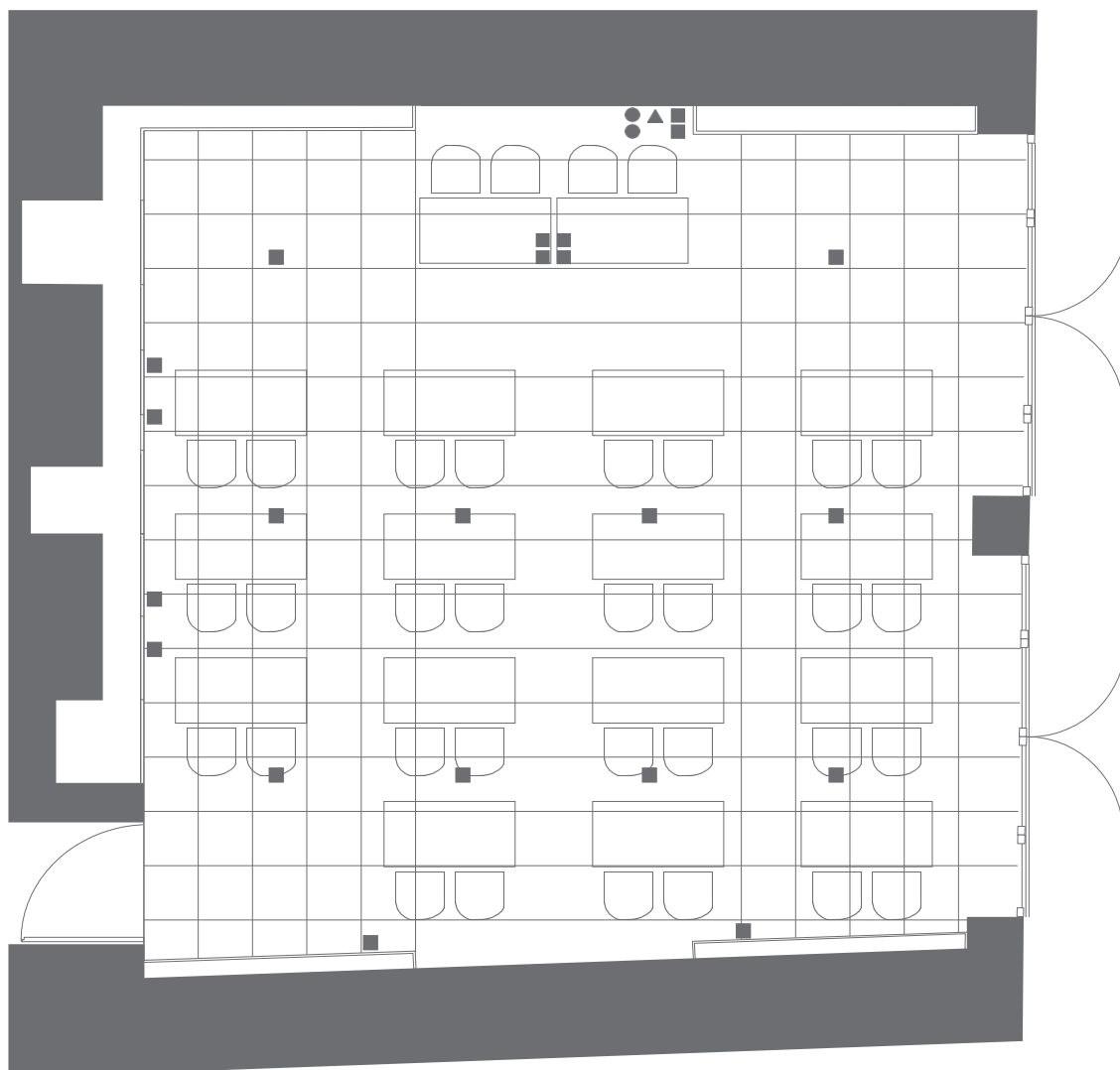

Hotel Gat Rossio

Rua jardim do Regedor, 27-35
1150-193 Lisboa
T.: +351 213 478 300
F.: +351 213 478 301
Whatsapp: +351 925 005 436
hotelgatrossio@gatrooms.com

gatrooms.com

Aula

Surface 58 m²
Capacity 34 pax

Internet WI-FI
Electrical point 220V
Data
T.V. plug



Grid 0,5 x 0,5 m

MALAGATA ROOM

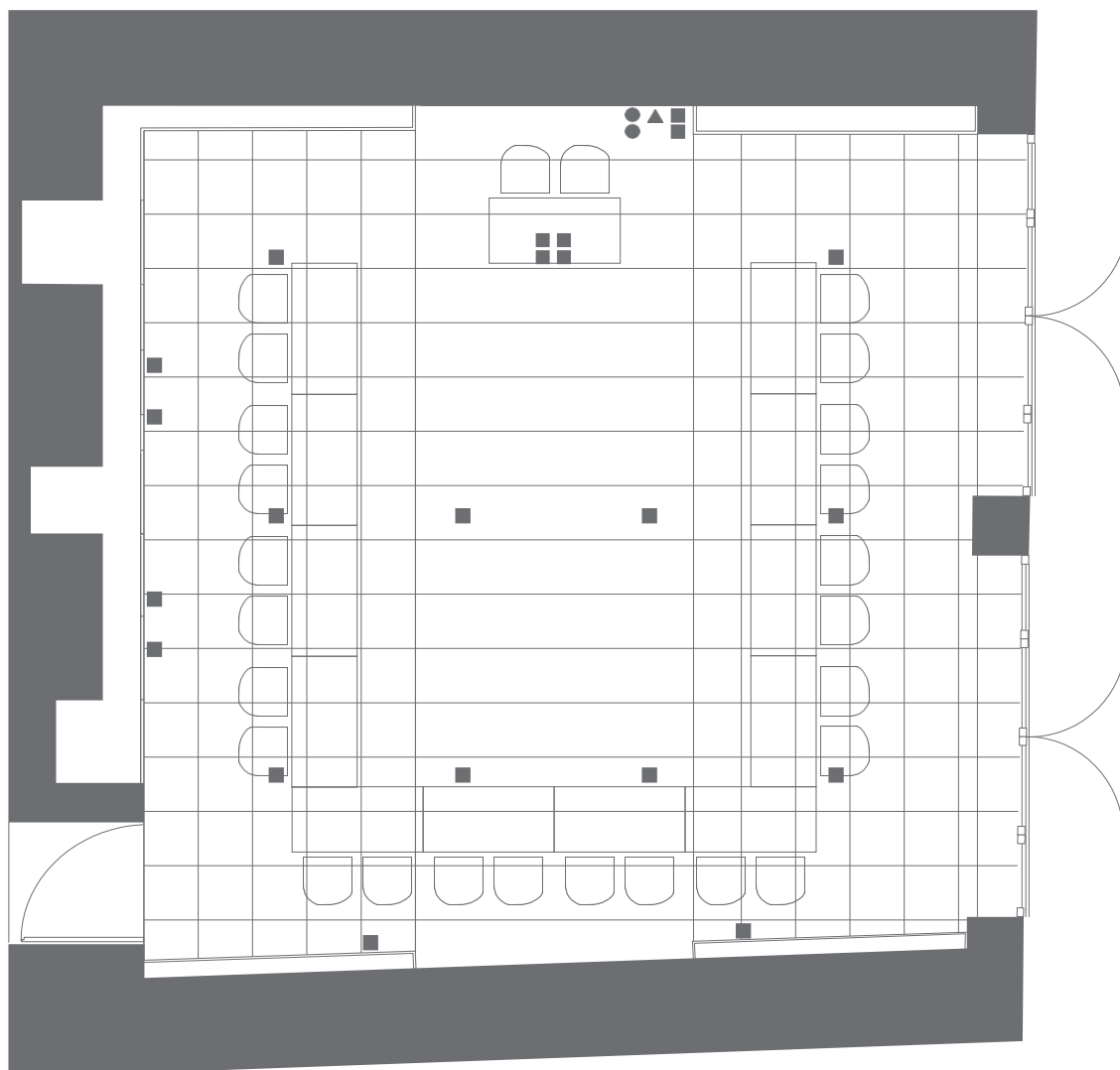

Hotel Gat Rossio

Rua jardim do Regedor, 27-35
1150-193 Lisboa
T.: +351 213 478 300
F.: +351 213 478 301
Whatsapp: +351 925 005 436
hotelgatrossio@gatrooms.com

gatrooms.com

U/O

Surface
Capacity

58 m²
28 pax

Internet WI-FI
Electrical point 220V
Data
T.V. plug



Grid

0,5 x 0,5 m

MALAGATA ROOM

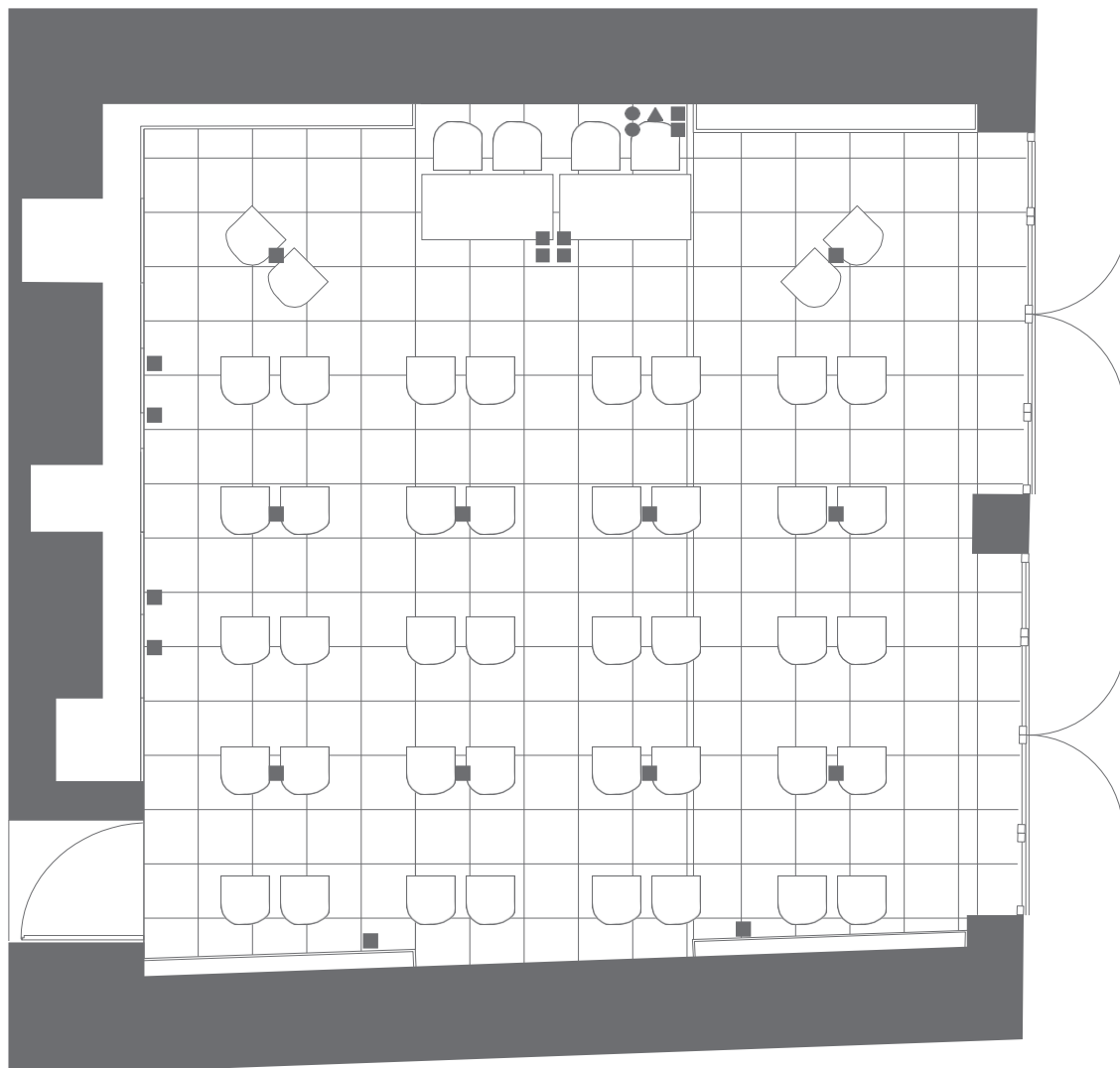

Hotel Gat Rossio

Rua jardim do Regedor, 27-35
1150-193 Lisboa
T.: +351 213 478 300
F.: +351 213 478 301
Whatsapp: +351 925 005 436
hotelgatrossio@gatrooms.com

gatrooms.com

Theatre

Surface 58 m²
Capacity 48 pax

Internet WI-FI
Electrical point 220V
Data
T.V. plug



Grid 0,5 x 0,5 m

MALAGATA ROOM

How to arrive

From Lisboa airport

Taxi: 10-15 minutes
Metro: 20-30 minutes
Aerobus: 20-35 minutes
Bus: 50-60 minutes

From Sete Rios train station

Taxi: 10 minutes
Metro: 20 minutes
Bus: 30 minutes

Location and rates:

<https://hotelgatrossio.com/es/localizacion>

How to travel by public transport in Lisbon

The city of Lisbon is served by a network of modern public transportation which provides excellent mobility both within the city center and its surrounding suburbs. Of this, the **Metro** is significant with its four lines that connects the river front, the north of the city and the suburbs of Amadora and Odivelas. The stations are open between 6:30am and 1:00am.

Other ways to get around the city are **tram**, **bus** and **funicular** which are all operated by Carris. As well as the routes which provide transportation between the center of the city and the historical area there are also special services for tourists and visitors with mobility difficulties. Do remember it is always cheaper to buy tickets and passes before the journey. For better mobility Carris and the Metro have created several passes to travel on both companies.

Lisboa Tickets and Travel Cards:

- Bus (1 journey), Tram (1 journey), Funicular (2 journeys)
 - Travel ticket Carris/Metro: (one hour)
 - Daily ticket Carris/Metro: (24 hours)
 - Zapping: Carris/Metro, boats and trains. (Rechargeable ticket)
-
- All tickets are for individual use only and are not transferrable.
 - Ticket validation is mandatory.

Information about ticket rates:

<http://www.carris.pt/en/fares-2018/>
<http://www.metrolisboa.pt/eng/>

Parking

Public parking 3 minutes from the hotel.

Empark, Parking Restauradores Open 24:00h

Location and rates:

<https://www.empark.com/pt/pt/parking/lisboa/restauradores/>

More information

www.gatrooms.com

Hotel Gat Rossio

Rua jardim do Regedor, 27-35
1150-193 Lisboa
T.: +351 213 478 300
F.: +351 213 478 301
Whatsapp: +351 925 005 436
hotelgatrossio@gatrooms.com

gatrooms.com

Hotel Gat Rossio
MALAGATA ROOM

